

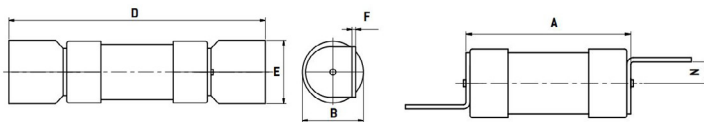

### AC3312

### 10A NS Fuse

550V AC 80kA / 250V DC 40kA, Overall length, H:61mm / Diameter: 13.5mm (Size F1)



Technical Specification	
Voltage (AC/DC)	550/250
Rating	10A
Breaking Capacity	40 kA
Dimensions (mm)	35.5 (A) 13.5 (B) 61 (D) 12.7 (E) 0.8 (F) 3.5 (N)
Pre Arcing I <sup>2</sup> T (AMPERE <sup>2</sup> SECONDS)	70
Total I <sup>2</sup> T (AMPERE <sup>2</sup> SECONDS)	350
Watt Loss	1.2
Curve Type	gG

3-AC3312-2021-V1