



AC448165

LED Panel emergency module

Features & Benefits

1. Non-Maintained > 3 hrs
3. Self-adhesive green/white dual colour LED Pad (stick on the corner of LED panel)
4. Push-wire terminal block included
5. 4 years battery life
6. Universal emergency module for all LED panels (including AC448160 and AC448161)
7. Fast fit and easy installation

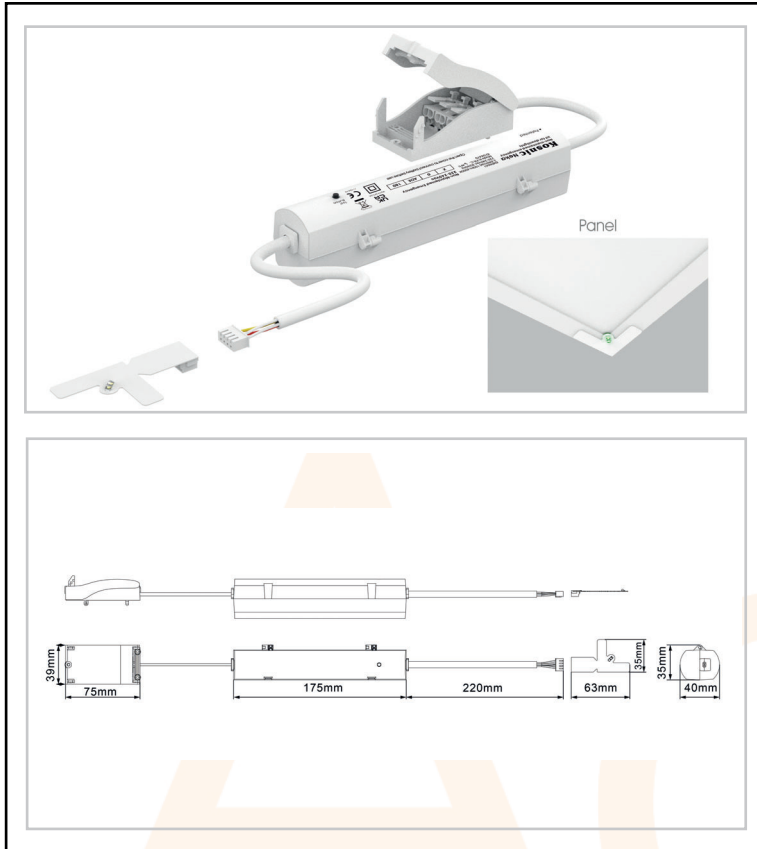

Technical Specification

Input Power (Max)	3.5w
Emergency output	2w
Power (w)	
Lumen (lm)	200lm
Input Voltage	220-240 Vac 50-60 Hz
Input Current (max)	22 mA
Protection	IP 20
CCT	6000k
Lifetime	30,000 hours
Ambient Temperature	0 to 45
Emergency Conversion	1
Time (s)	
Emergency Operating	3
Time (h)	
Battery charging time (h)	24
Battery life (Years)	4
Battery Type	Li-Ion
Battery Capacity (mAh)	2600
Battery Voltage	3.6
Dimensions LxWxD (mm)	175 x 35 x 40
Warm-up time to 60%	Instant full light

4-AC448165-2023-V1