



AC71054

External Bend for ½ Round (30x15mm) White Mini Trunking

Use to join lengths around 90° outside corners

Clip over snap-on design for AC71050 (2m) & AC71051 (3m) white Mini trunking installations

Paintable - first key surface, for best results

'Quick to install, looks great!'

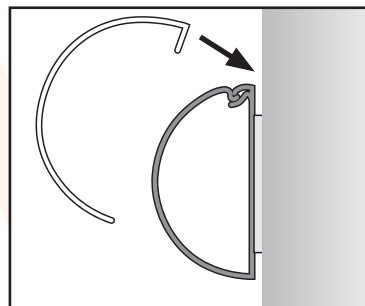

All Clip-Over accessories have grip tabs. The grip tab simply clips over the top of the length.

Technical Specification

Use with 30x15mm ½ round White Mini trunking - AC71050 (2m) & AC71051 (3m)

Rear grip tabs secure trunking & accessory

PVC

Paintable - first key surface, for best results

7-AC71054-2022-V1